



RB520CS-30

SCHOTTKY BARRIER DIODE



1. FEATURES

- We declare that the material of product compliance with RoHS requirements and Halogen Free.
- Low current rectification
- Low IR
- High reliability.
- Silicon epitaxial planar

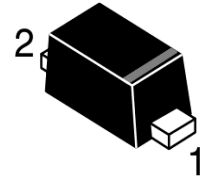

SOD-923

2. DEVICE MARKING AND ORDERING INFORMATION

Marking : E

3. MAXIMUM RATINGS(Ta = 25°C)

Parameter	Symbol	Limits	Unit
DC reverse voltage	VR	30	V
Average rectifierd forward current	IO	100	mA
Forward current surge peak(60Hz · 1cyc)	IFSM	500	mA
Junction temperature	Tj	125	°C
Storage temperature	Tstg	-40~+125	°C

4. ELECTRICAL CHARACTERISTICS

Characteristic	Symbol	Min.	Typ.	Max.	Unit
Forward voltage (IF =10mA)	VF	-	-	0.45	V
(IF =20mA)		-	-	0.5	
Reverse current (VR =10V)	IR	-	-	0.5	μA



5.ELECTRICAL CHARACTERISTICS CURVES

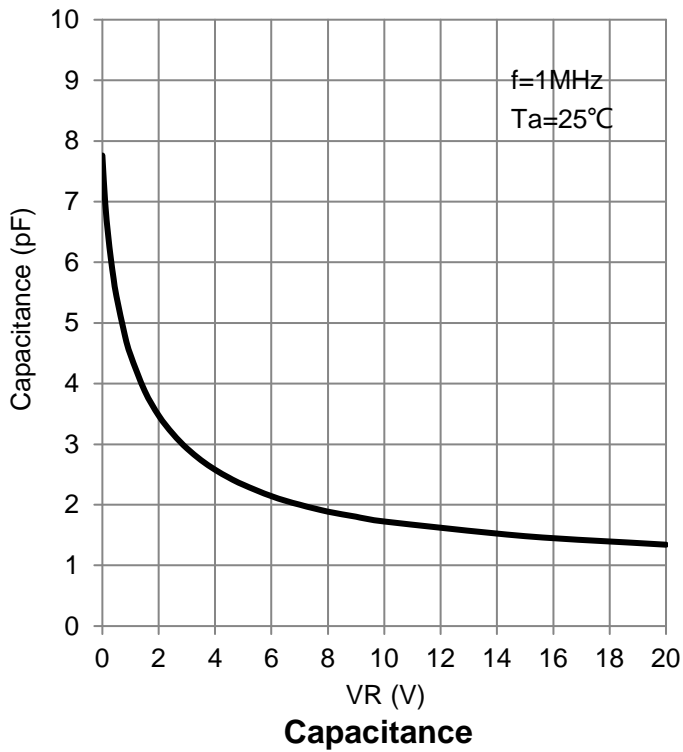
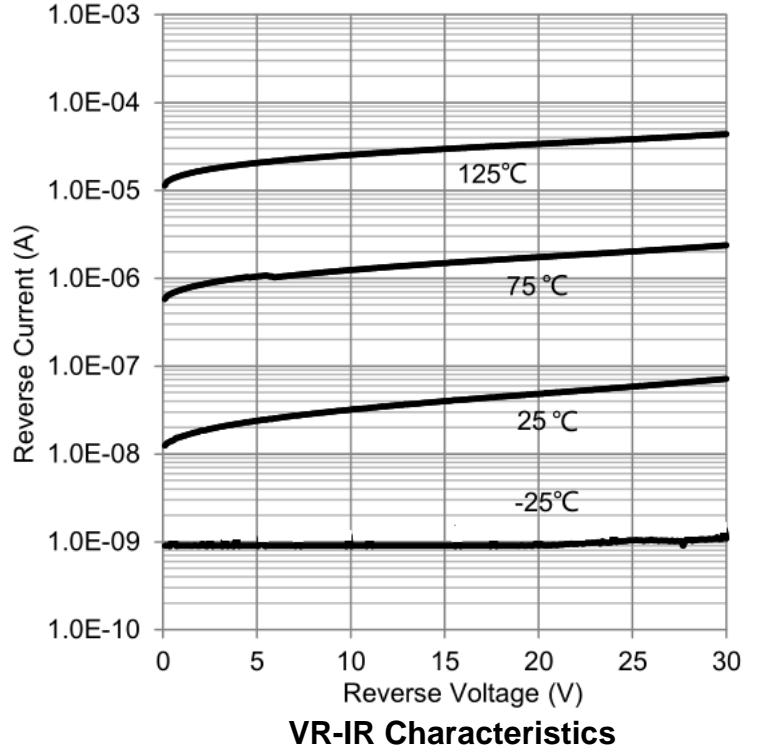
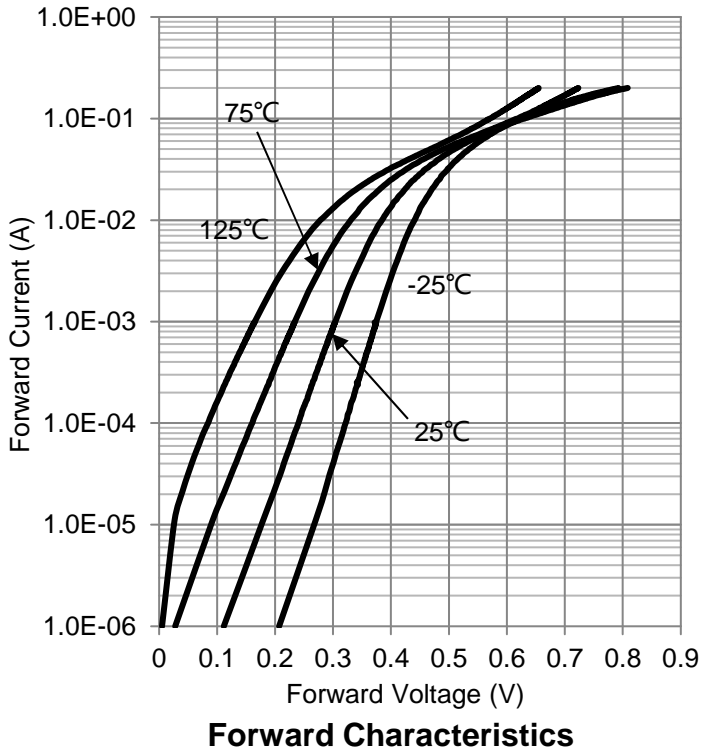

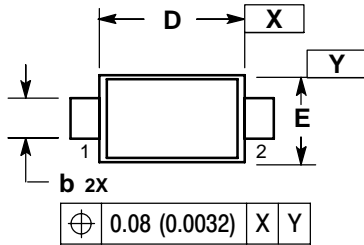

DIM	MILLIMETERS			INCHES		
	MIN	NOM	MAX	MIN	NOM	MAX
A	0.35	0.40	0.45	0.013	0.016	0.020
b	0.20	0.25	0.30	0.008	0.010	0.012
c	0.07	0.12	0.17	0.003	0.005	0.007
D	0.75	0.80	0.85	0.030	0.031	0.033
E	0.55	0.60	0.65	0.022	0.024	0.026
H _E	0.95	1.00	1.05	0.037	0.039	0.041
L	0.07	0.10	0.15	0.003	0.004	0.006

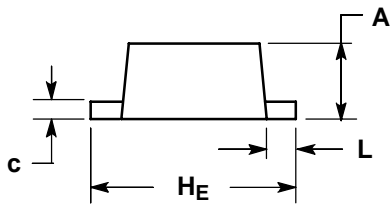

SOLDERING FOOTPRINT

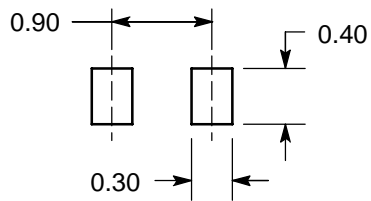

DIMENSIONS: MILLIMETERS